

PHS01
PHS01-B

Tech Tub for Phone Storage



Assembly Guide

Check out our other products online at www.copernicused.com

For assistance, please contact us by telephone at **1-800-267-8494** or email at info@copernicused.com.

Have your packing slip ready for reference.

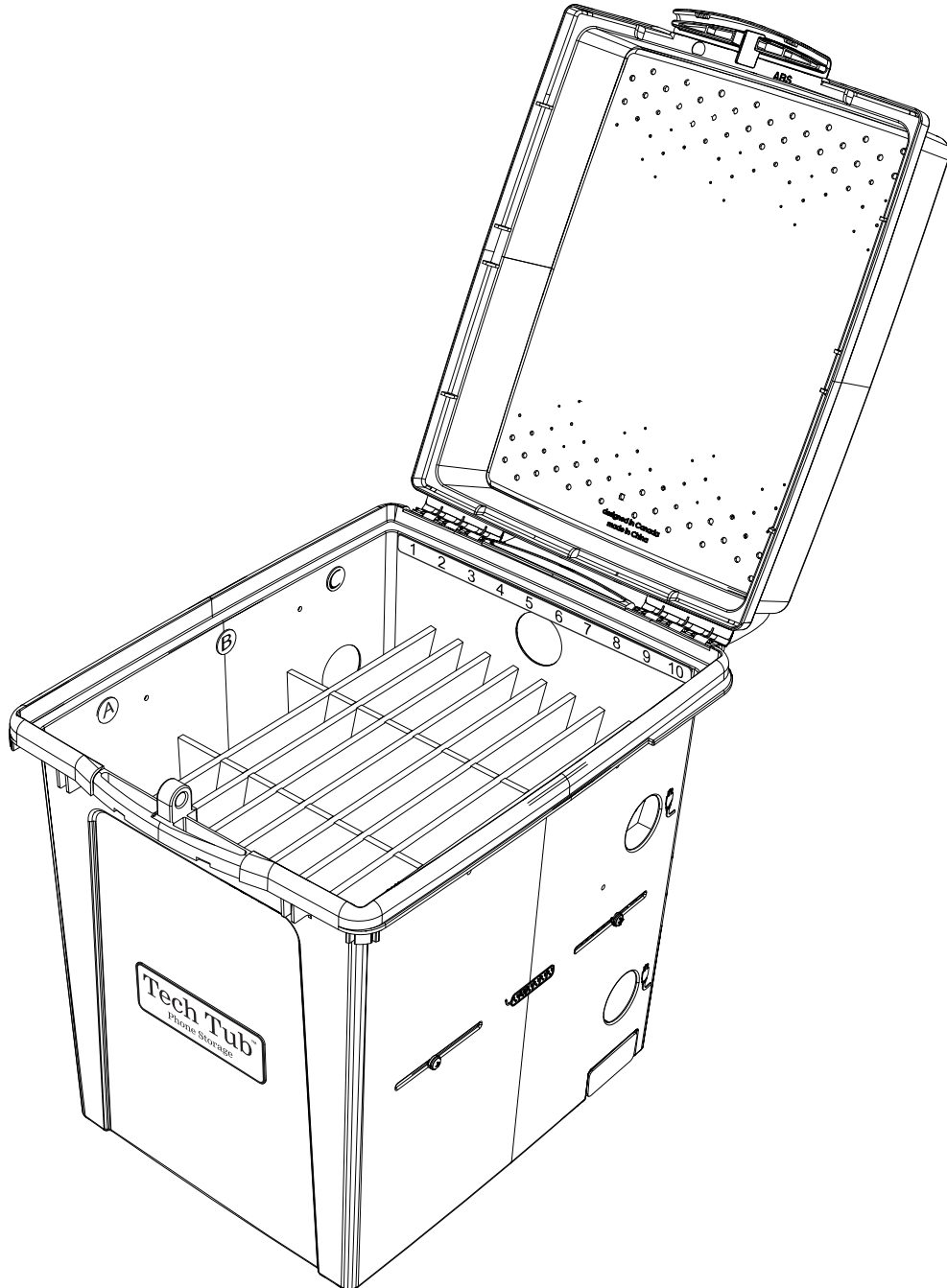

Please Recycle

Customer Service & Warranty Information

Dear Educator,

Thank you for purchasing the Premium Tech Tub for Phone Storage and the Base Tech Tub for Phone Storage. We hope it meets your expectations and you and your students enjoy using it at your school.

Every day we see and hear stories of teachers going above and beyond to help students thrive. Thank you so much for all you do – you are awesome, and you make a difference.

Thank you for inspiring us.

If you have any questions, concerns or ideas on how we can improve please let us know by contacting our Customer Solutions Ninjas at 1-800-267-8494 or info@copernicused.com.

Happy teaching,

Kaylyn Belcourt, President
kaylyn@copernicused.com



For missing parts and other issues regarding your product:

Please contact Customer Service, where we will be happy to help.

Telephone: 1-800-267-8494, Monday - Friday 8:00am - 4:30 pm EST

Email: info@copernicused.com

Need Support? Have a Question?



Email Customer Service

Check out some of our other great products!



www.copernicused.com



Register your Product

Registering your warranty ensures we have all the information we need to make any future warranty claims quick and easy. Please visit www.copernicused.com/warranty and complete the form within 10 business days from product assembly. By registering your product, you will be entered into a draw to win Copernicus product.

Make a Warranty Claim

We offer a Lifetime Warranty on almost everything we make. Please call **1-800-267-8494** or email info@copernicused.com to start your warranty claim. Proof of purchase will be required upon warranty claim (i.e. copy of invoice).

Tips for Assembly

Before You Begin:

- Lay out and identify all of the included parts.
- The hardware has been packed according to step
- Read the assembly guide over once to familiarize yourself with them.

As You Assemble the Unit:

- Follow the steps in sequence.
- Before beginning each step, find the part(s) that you need for that step.
- The title of each step states what you will be doing. Review the text and the pictures as you build the unit.

Watch for These Helpful Symbols:



2-Person Task

For safety, please have someone help you when working on steps displaying this symbol.



The symbol denotes a step needing extra attention to ensure it is done correctly.



Important Information! Warning!

Please read the warnings below for important safety information regarding your product. Failure to read these warnings or to follow the instructions below could result in personal injury or damage to your product that could void your warranty.



Small Parts

In its unassembled state, this product contains parts that can be hazardous to small children. This product should be assembled by an adult.



Adult Supervision

This product is to be used under the supervision of an adult.



Indoor Use Only

This product is intended for indoor commercial use only. To reduce the risk of fire or electric shock, do not expose this product to rain or moisture. The internal components are not sealed from the environment.

Parts

Before beginning, you should have:

Additional tools required:

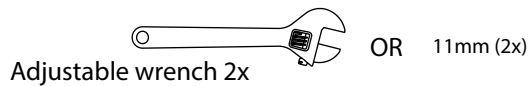

PHS01-B

PHS01-B
x1

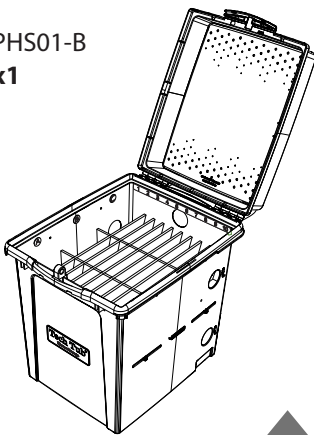

Padlock
x1
(x2 for PHS01)

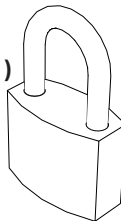

Key
x3
(x6 for PHS01)

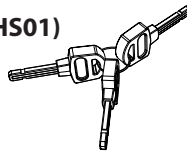

PHS01 Hardware Actual Size

(A)

M6 Washer
x6



(B)

M6 Lock Nut
x2



(C)

M6 x 70mm
Screw
x2



PHS01 (ONLY)

In Box 1

Locking Pin
x1
(31079)

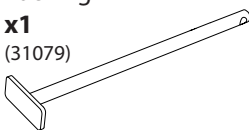

Locking Block
x1
(31078)

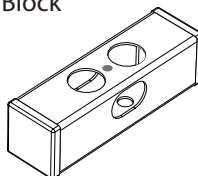

In Box 1

Tools (Not to Scale)

Allen Key
(43281)

1x
(x2 for PHS01)

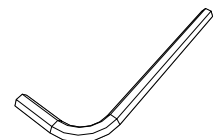

1

You will need: (Not to Scale)

Store phones in slots provided inside the tub.

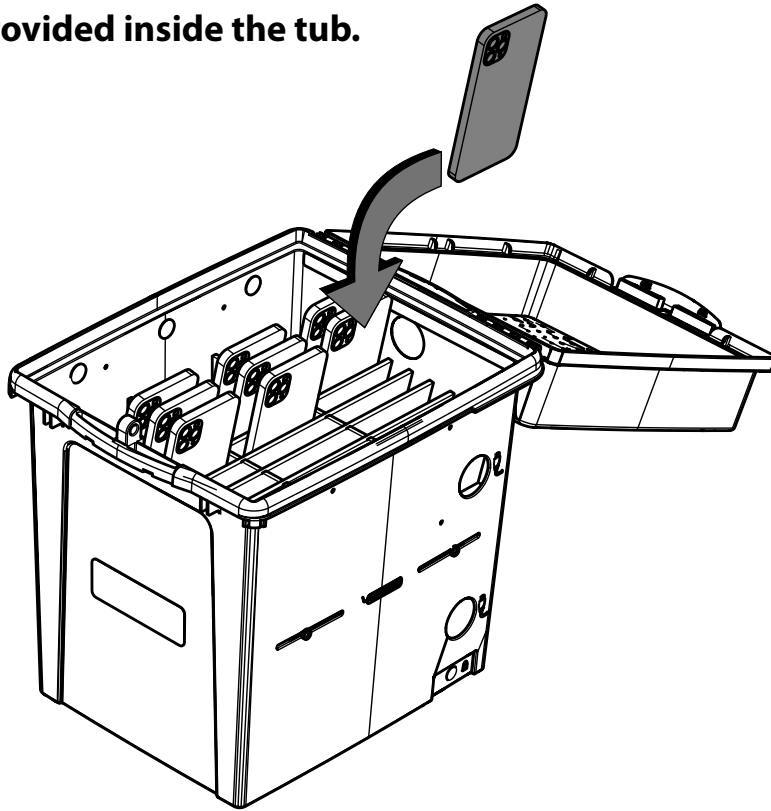

2

You will need: (Not to Scale)

Lock lid with padlock if desired

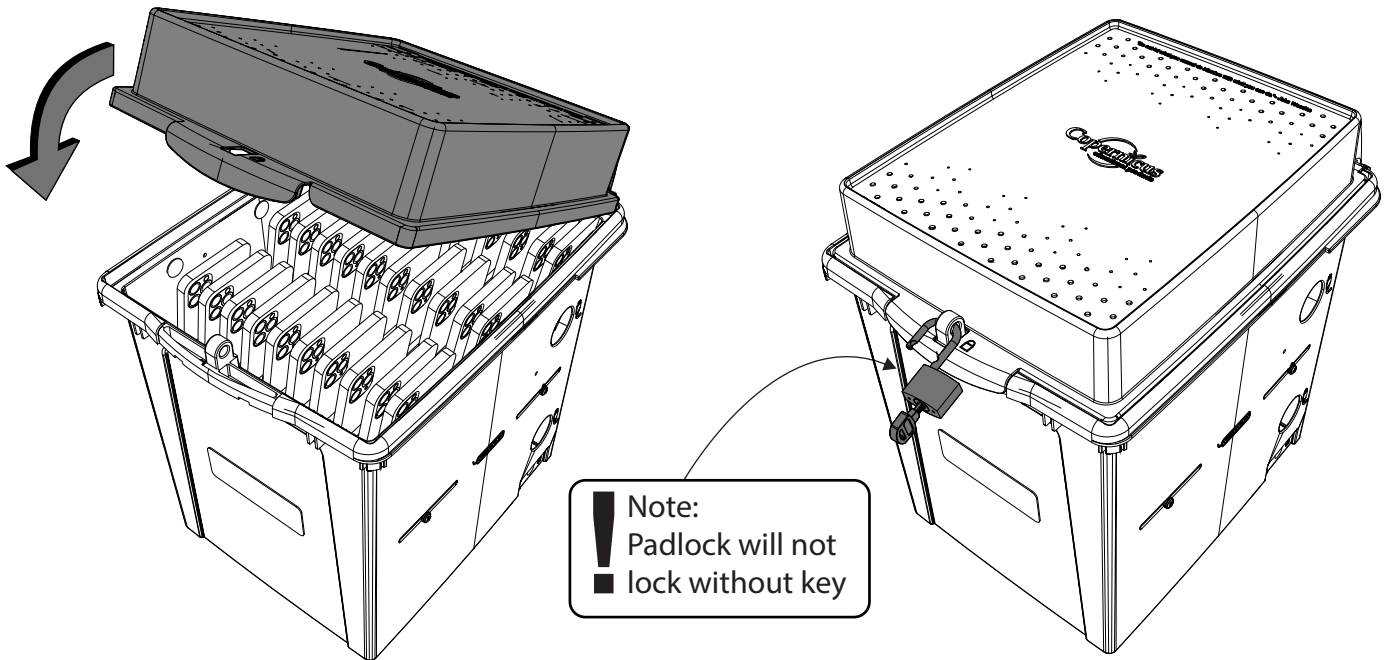

PHS01 only: Follow OPTIONAL Steps 3 to 5 to install the Tech Tub® Locking Block and Locking Pin System

3

You will need: (Not to Scale)

★ This system allows you to lock your Tech Tub® to a table or countertop. This is a really good idea if you leave your devices out in the open or your room doesn't lock. Once the Tech Tub® is secured in place you can lock the tub lid to secure your devices.

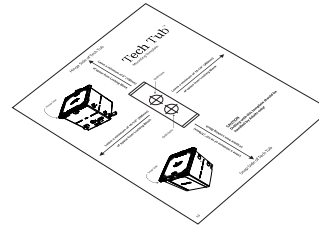

Positioning Template (found at back of this guide)
x1

Use Template and Drill Holes into Surface

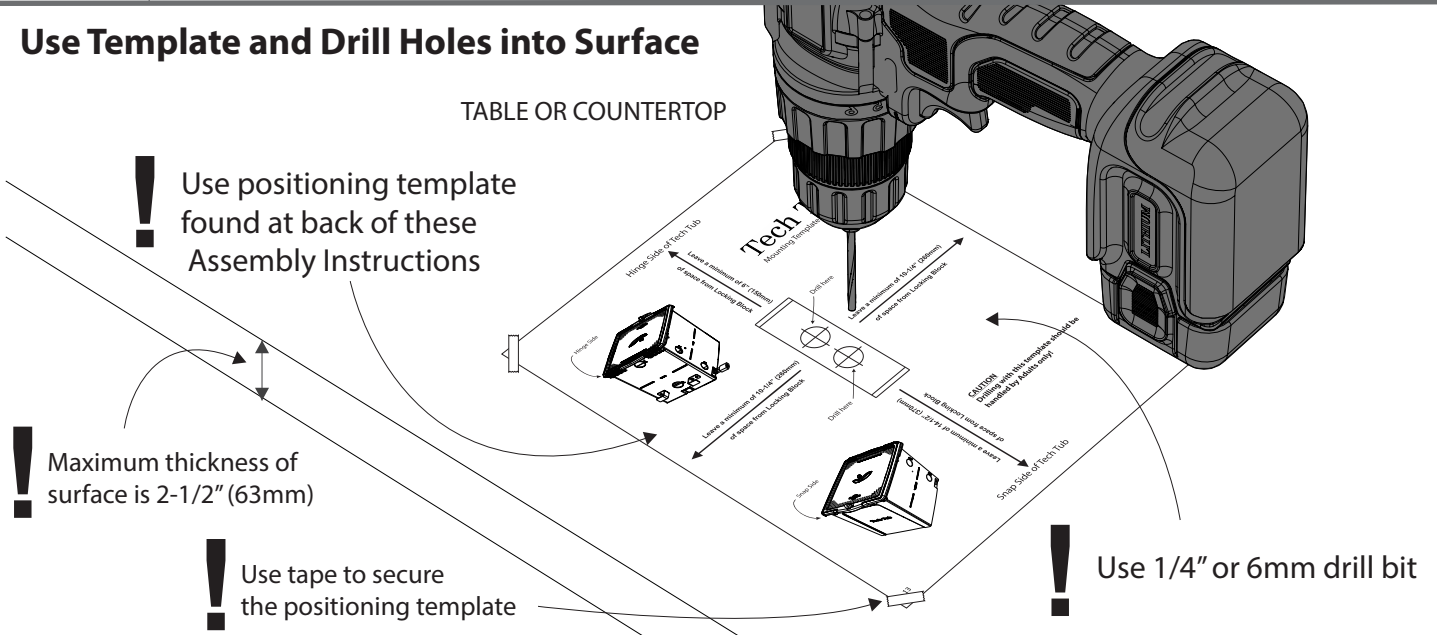

4

Actual Size:

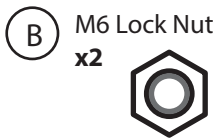
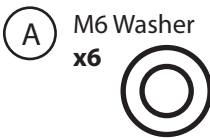

You will need: (Not to Scale)

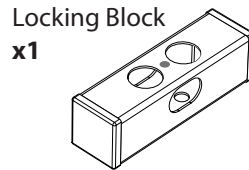

Mount Locking Block

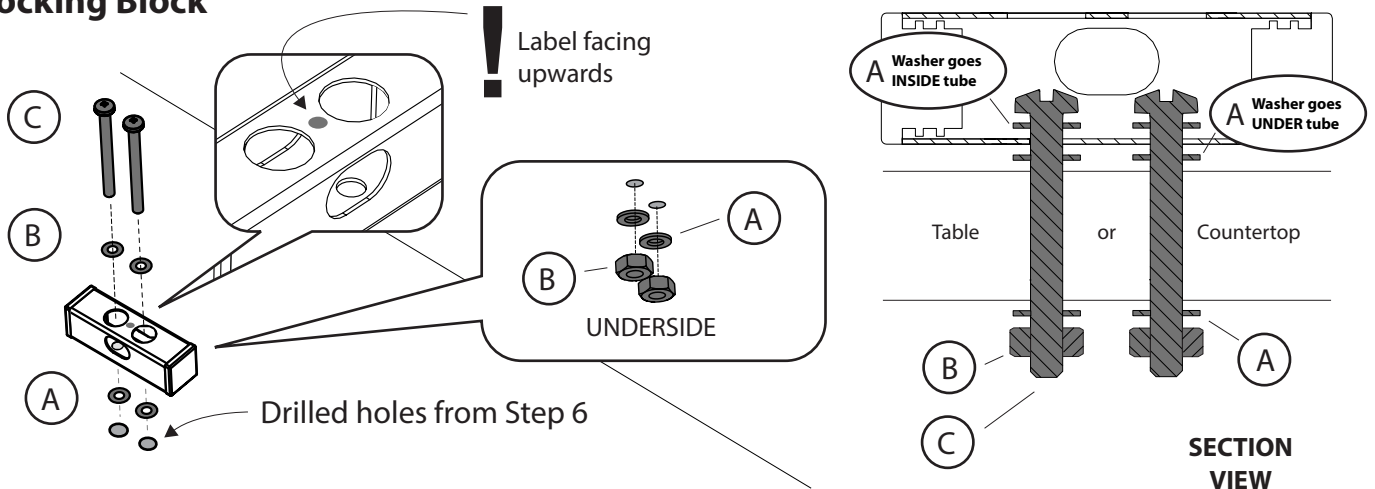

PHS01 only: Follow OPTIONAL Steps 3 to 5 to install the Tech Tub® Locking Block and Locking Pin System

5

You will need: (Not to Scale)

Padlock
x1

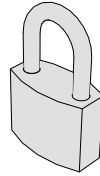

Key
x3

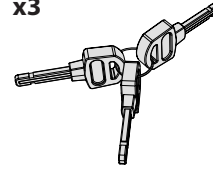

Locking Pin
x1

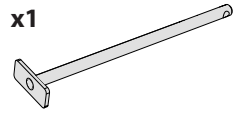

Lock the Tech Tub® with Locking Pin

1 Push Tech Tub® onto Locking Block

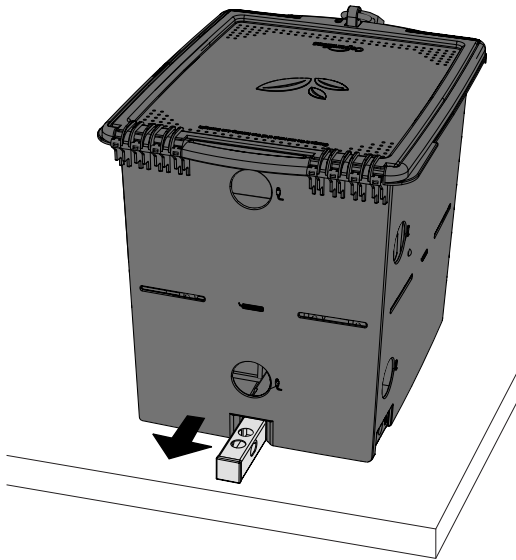

2 Push Tech Tub® all the way back until the Locking Block is completely in channel.

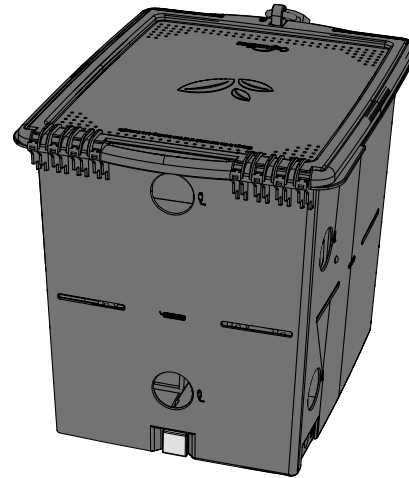

3 Slide Locking Pin through hole on Tech Tub®

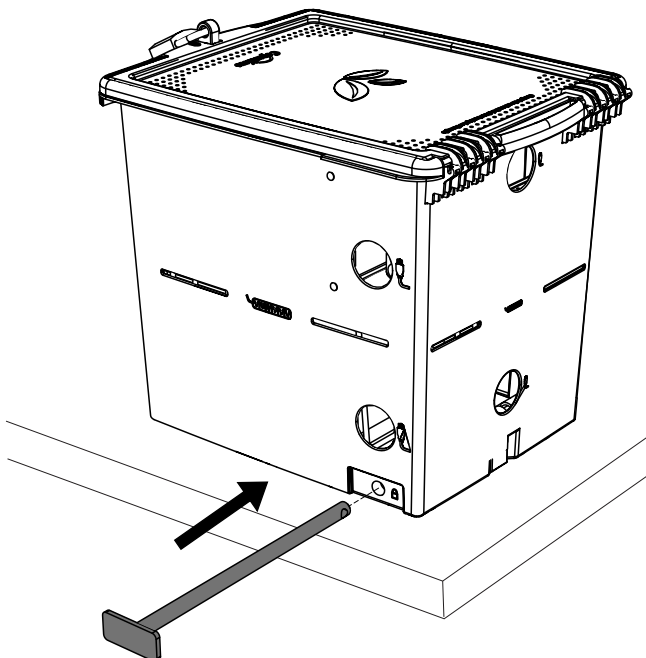

4 Secure Locking Pin with Padlock on other side.

