

TEC57

# Tech Tub<sup>®</sup> Base



## Assembly Guide TEC57\_2019\_A

Check out our other products online at  
[www.copernicused.com](http://www.copernicused.com)

For assistance, please contact us:

**1-800-267-8494**

Email [info@copernicused.com](mailto:info@copernicused.com)

Have your packing slip ready for reference

## WARNING !

- This product is meant to be assembled by an adult.
- In its unassembled state, small parts present a hazard.
- To be used under direct supervision of an adult.

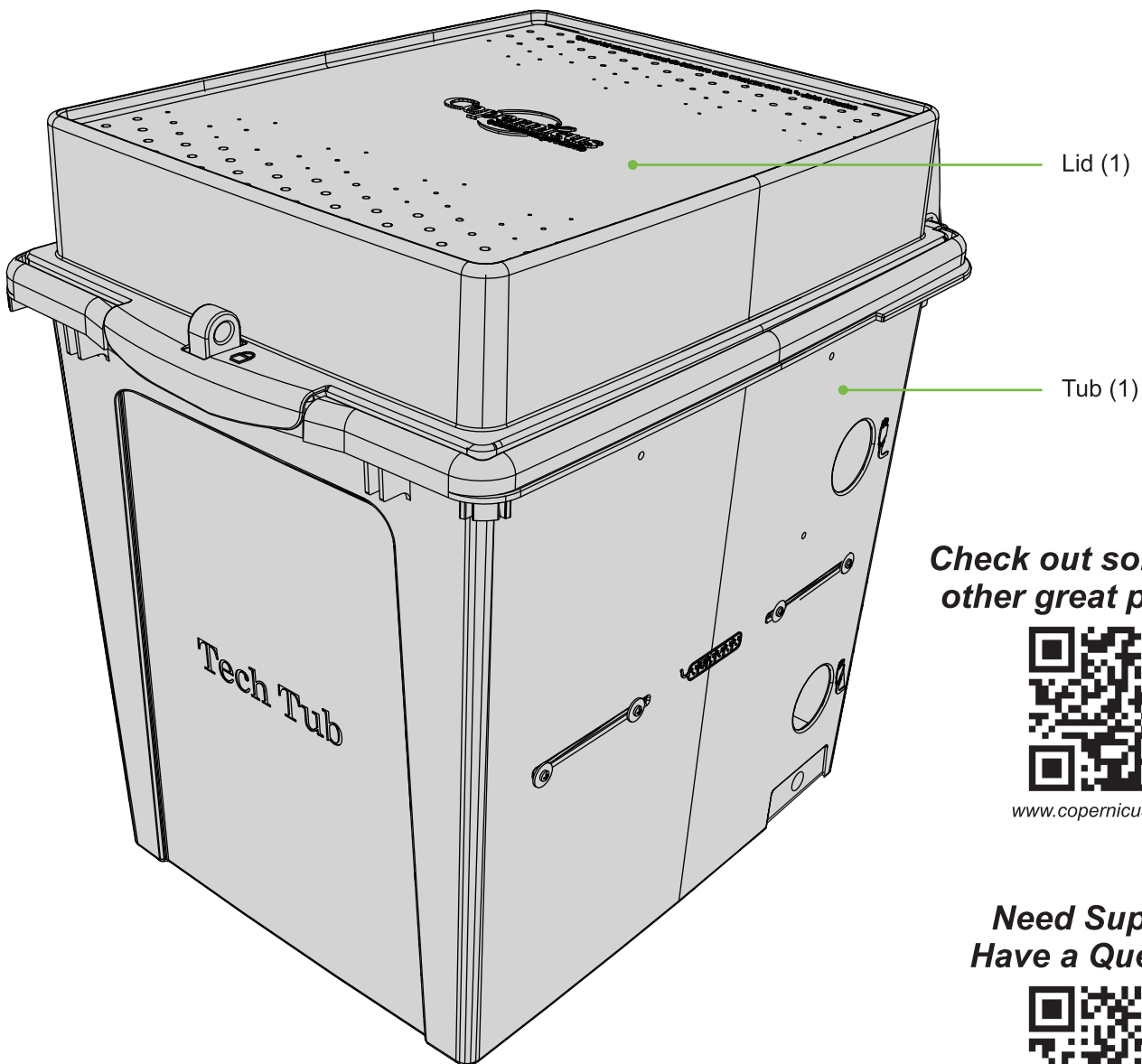

**Check out some of our  
other great products!**



[www.copernicused.com](http://www.copernicused.com)

**Need Support?  
Have a Question?**



Email our Customer Support



**Please Recycle**



## Assembly Guide TEC57\_2019\_A

Check out our other products online at  
[www.copernicused.com](http://www.copernicused.com)

For assistance, please contact us:

**1-800-267-8494**

Email [info@copernicused.com](mailto:info@copernicused.com)

**Have your packing slip ready for reference**

Dear Educator,

Thank you for purchasing the Tech Tub® Base. We hope it meets all your expectations and you and your students enjoy using it at your school.

If you have any questions, concerns or ideas on how we can improve please let us know by contacting our Customer Solutions Ninjas at 1-800-267-8494 or [info@copernicused.com](mailto:info@copernicused.com).

Happy teaching,

Kaylyn Belcourt-McCabe  
President

We do not inherit the earth from our ancestors, we borrow it from our children.

Change is the end result of all true learning.

LEO BUSCAGLIA

NORTH AMERICAN

PROVERB

What you leave behind is not what is engraved in stone monuments, but what is woven into the lives of others.

PERICLES

Education is the most powerful weapon which you can use to change the world.

NELSON MANDELA



### Validate Your Warranty

To validate your warranty, submit the ON-LINE form at [www.copernicused.com](http://www.copernicused.com)  
**Enter a draw to win a Copernicus Product for your classroom at the same time!**





# Warning! Hazard Risks!

Please read the warnings below for important safety information regarding your product. Failure to read these warnings or to follow the instructions below could result in personal injury or damage to your product that could void your warranty.



Small Parts

In its unassembled state, this product contains parts that can be hazardous to small children. This product should be assembled by an adult.



Adult Supervision

This product is to be used under the supervision of an adult.



Indoor Use Only

This product is intended for indoor use only. To reduce the risk of fire or electric shock, do not expose this product to rain or moisture. The internal components are not sealed from the environment.

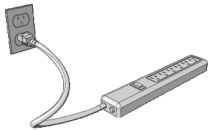

Power Strip Specifications

Read your power strip electrical specifications. Only plug in devices that are approved for use with this power strip. Connect the supplied power strip directly to a wall outlet. **Do not connect to another power strip or use an extension cord.** Unplug when not in use. **Do not leave this product plugged in for more than 72 consecutive hours.** Turn off power strip before unplugging.

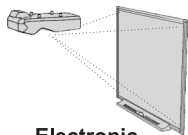

Electronic Equipment

Read the electrical specifications of any electronic equipment you are using with your Copernicus products. Failure to read these specifications and follow their instructions could result in damage to your equipment or personal injury.



Cable Trip Hazard

Ensure that any cables extending across the floor to your product are properly bundled and marked to avoid tripping or falling which may lead to personal injury.



Electrical Shock

Do not install or use the electrical components of this unit during a lightning storm.



Climb Hazard

Do not climb on, hang from or suspend objects from any components of your product unless otherwise specified.



**Before beginning, you should have:**

Contents - TEC57

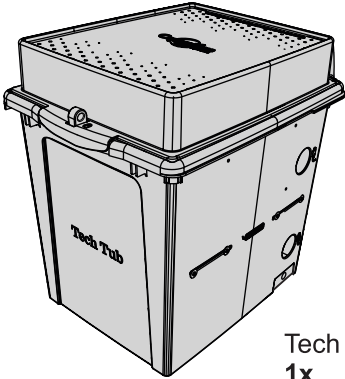

Tech Tub<sup>®</sup>  
1x

Optional Accessories

Add-ons - TEC-AC1000

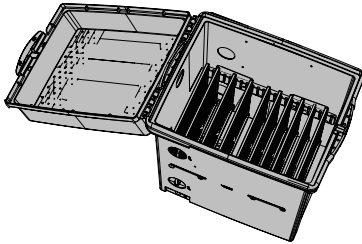

*Tech Tub<sup>®</sup> not included*

- Divider **10x**
- Rail **2x**
- Spacer **2x**
- Foam Pad **1x**

Add-ons - TEC-AC100

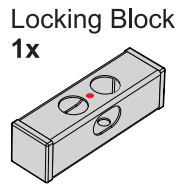

Locking Block  
**1x**

Locking Pin  
**1x**

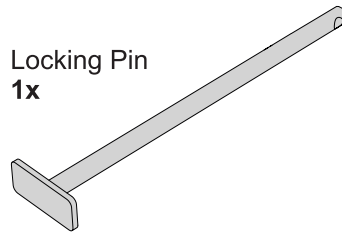

Add-ons - 430440

Padlock  
**1x**

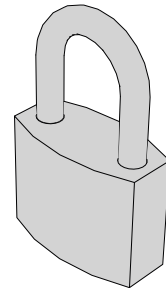



# Tips for Use

## Cable Management

Route your device cables through the cable holes on the sides or rear of the Tech Tub®.

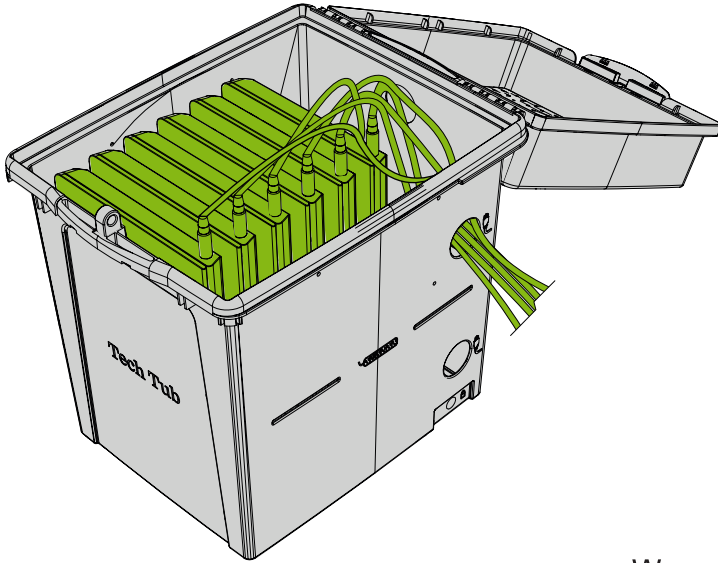

Laptop and Chromebook Storage

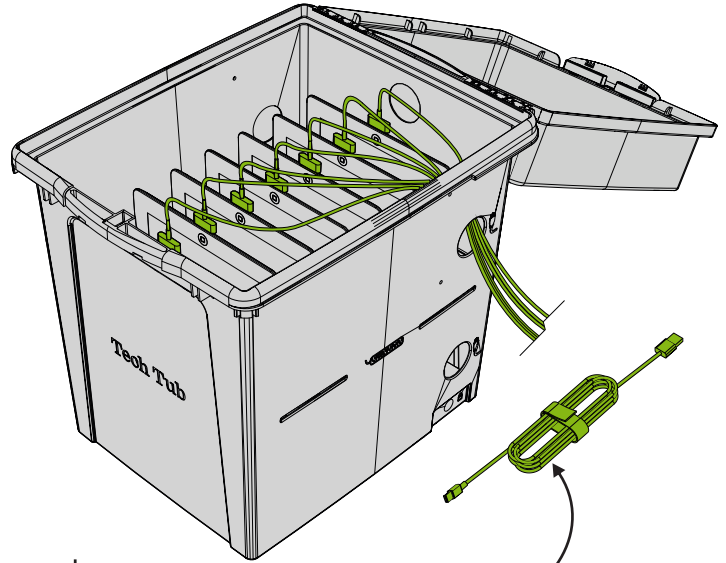

We recommend you bundle your cables with Hook & Loop Straps!

## Device Management

Keeping track of your devices can be made even easier by creating a sign-out program.

There are many automated software solutions available that make setting up and running a device check-out program very easy.

Here is a list of some companies and their products:

*ResourceMate® - [www.resourcemate.com](http://www.resourcemate.com)*

*Neuton Data Systems - [www.neuton.net](http://www.neuton.net)*

*IntelliScanner - [www.intelliscanner.com](http://www.intelliscanner.com)*

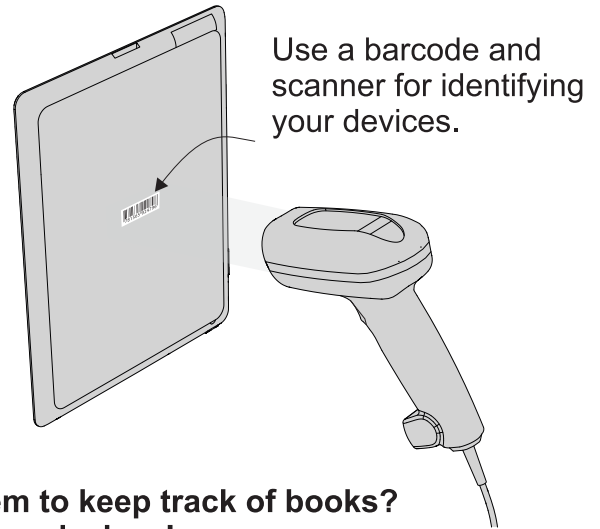

Use a barcode and scanner for identifying your devices.



**Does your school already use an automated system to keep track of books? You could use this system to also keep track of your devices!**

## Carrying your Tech Tub®

Use the Handles along the sides of the Tech Tub® for easy lifting and carrying.

